

# MORGAN AND MORECAMBE OFFSHORE WIND FARMS: TRANSMISSION ASSETS

## Indicative Extent of Marine Licences and Grid Coordinates Plan



September 2024  
Rev: F01

MOR001-FLO-CON-ENV-TEC-0008  
MRCNS-J3303-JVW-10008

PINS Reference: EN020028  
APFP Regulations: 5(2)(o)  
Document reference: B4

<b>Document status</b>					
<b>Version</b>	<b>Purpose of document</b>	<b>Approved by</b>	<b>Date</b>	<b>Approved by</b>	<b>Date</b>
F01	For issue	AS	September 2024	IM	September 2024

**Prepared by:**

**Morgan Offshore Wind Project Limited,  
Morecambe Offshore Windfarm Ltd**

**Prepared for:**

**Morgan Offshore Wind Project Limited,  
Morecambe Offshore Windfarm Ltd**



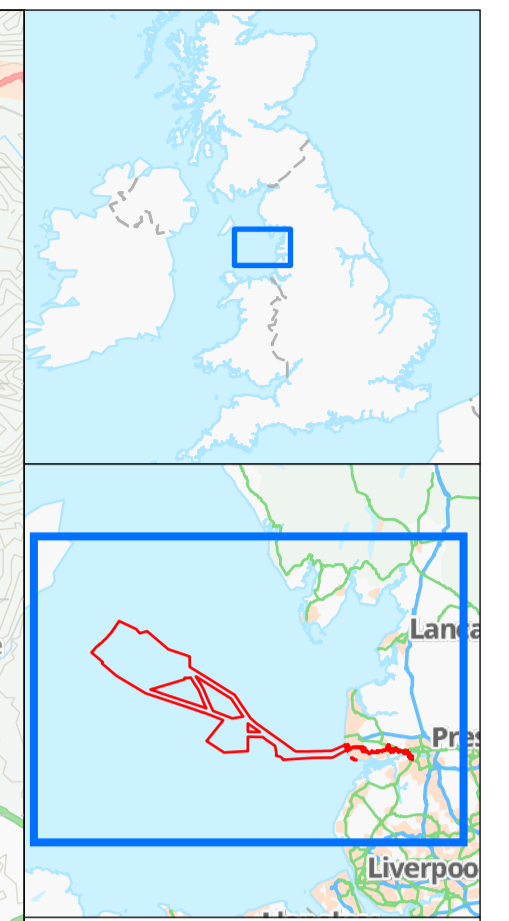
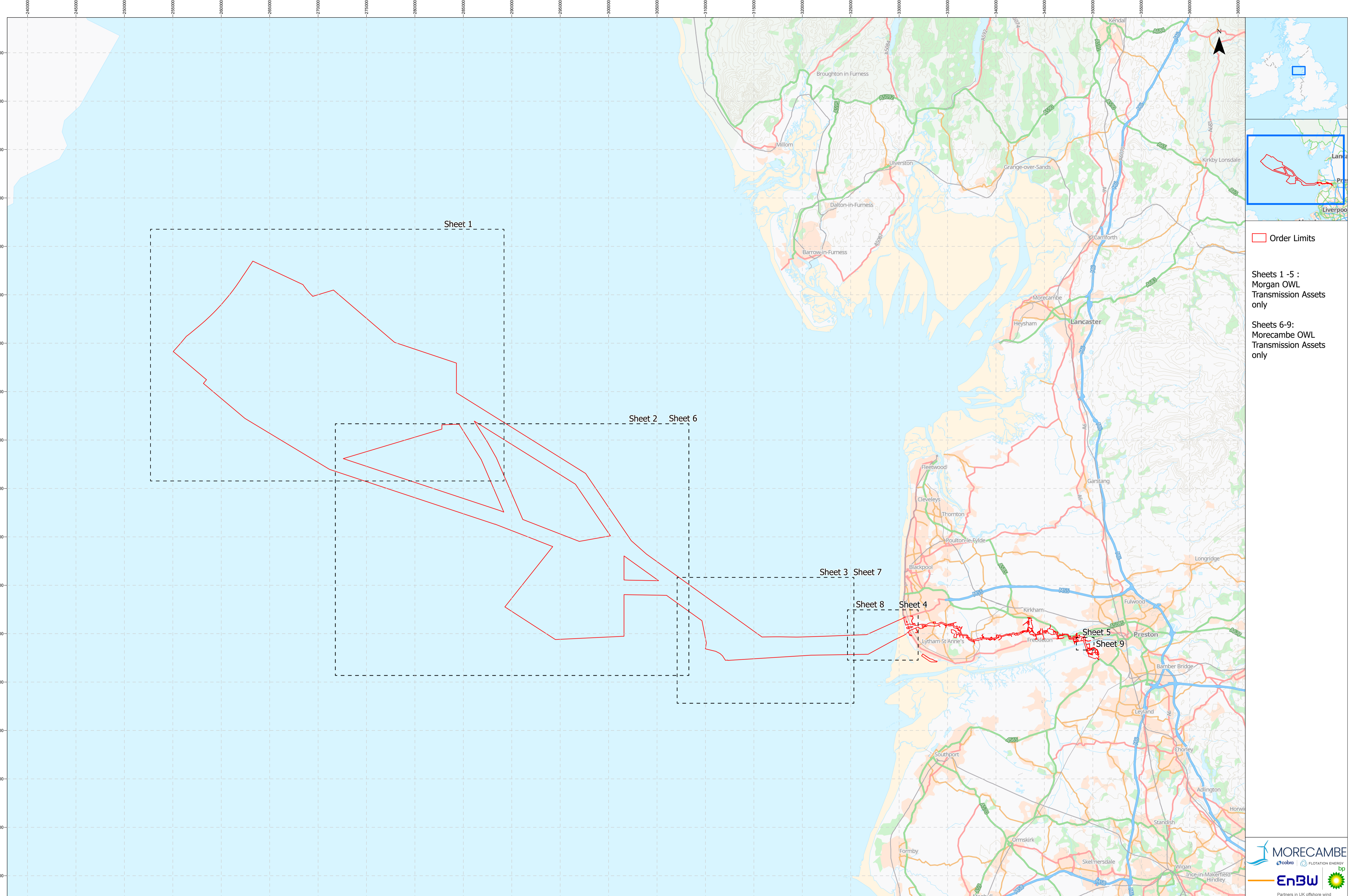

Order Limits

Sheets 1 -5 :  
Morgan OWL  
Transmission Assets  
only

Sheets 6-9:  
Morecambe OWL  
Transmission Assets  
only

**Project Name:**  
MORGAN AND MORECAMBE OFFSHORE WIND FARMS:  
TRANSMISSION ASSETS

**Drawing Title:**  
Indicative Extent of Marine Licences - Index  
AFPF Reg: 5(2)(o)  
Document Reference: B4

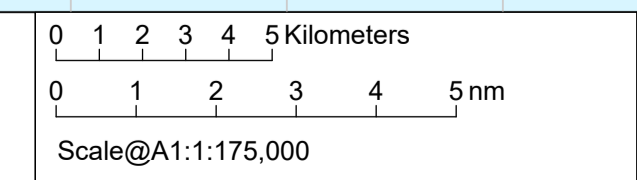

**Geodetic Information:**  
Datum: OSGB 1936  
Projection: British National Grid

**Data Sources:**BP, Ordnance Survey  
Based Upon The Ordnance Survey Map With The Sanction Of The  
Controller Of HM Stationary Office. Crown Copyright Reserved. © OS  
Licence No. 100042124

**Service Layer Credits:** GB Cartographic Local Names:  
Contains OS data © Crown Copyright and database right  
2022  
Contains data from OS Zoomstack

VER	DATE	DETAILS	AUTH	CHK	APPRV
01	20/09/24	Final at DCO Submission	HAH	LM	AS

**Drawing Number:**  
BP-GBR-MORG-REG-0172





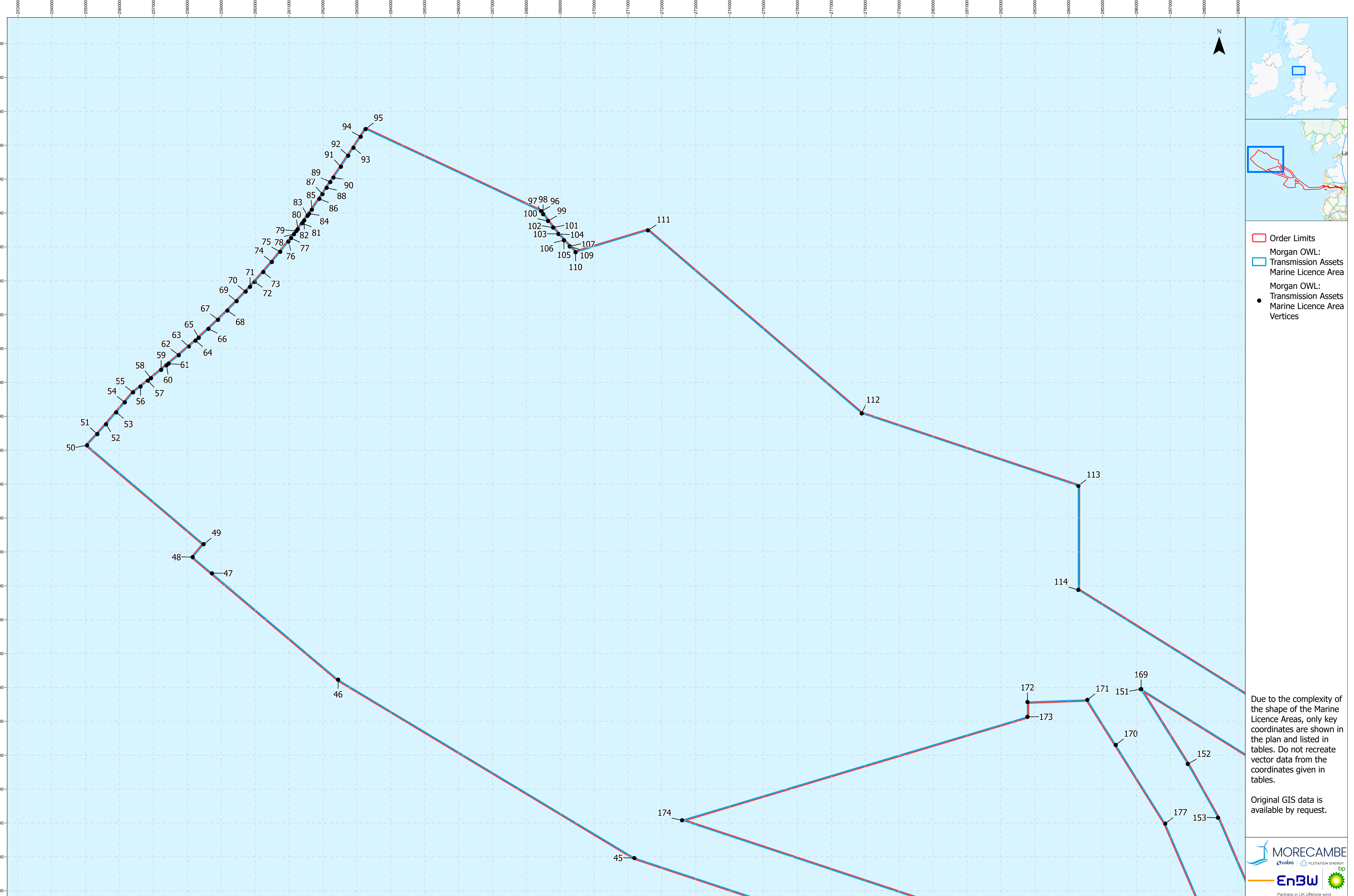

**Project Name:**  
MORGAN AND MORECAMBE OFFSHORE WIND FARMS:  
TRANSMISSION ASSETS

**Drawing Title:**  
Indicative Extent of Marine Licences -Sheet 1 of 9  
AFPF Reg: 5(2)(o)  
Document Reference: B4

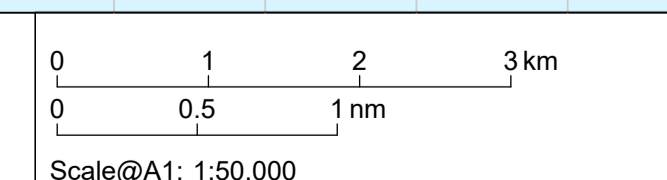

**Geodetic Information:**  
Datum: OSGB 1936  
Projection: British National Grid

**Data Sources:**BP, Ordnance Survey  
Based Upon The Ordnance Survey Map With The Sanction Of The  
Controller Of HM Stationery Office. Crown Copyright Reserved. © OS  
Licence No. 100042124

**Service Layer Credits:** GB Cartographic Local Names:  
Contains OS data © Crown Copyright and database right  
2022  
Contains data from OS Zoomstack

VER	DATE	DETAILS	AUTH	CHK	APPRV
01	20/09/24	Final at DCO Submission	HAH	LM	AS

**Drawing Number:**  
BP-GBR-MORG-REG-0182



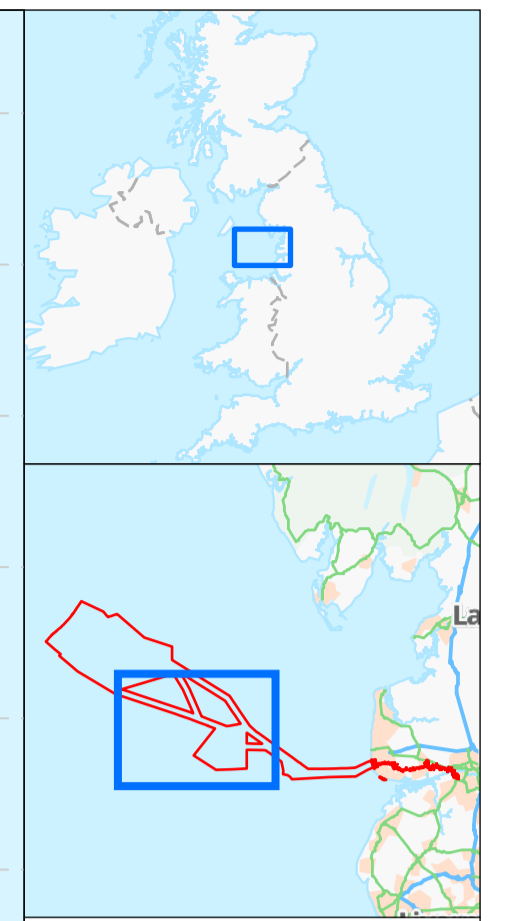
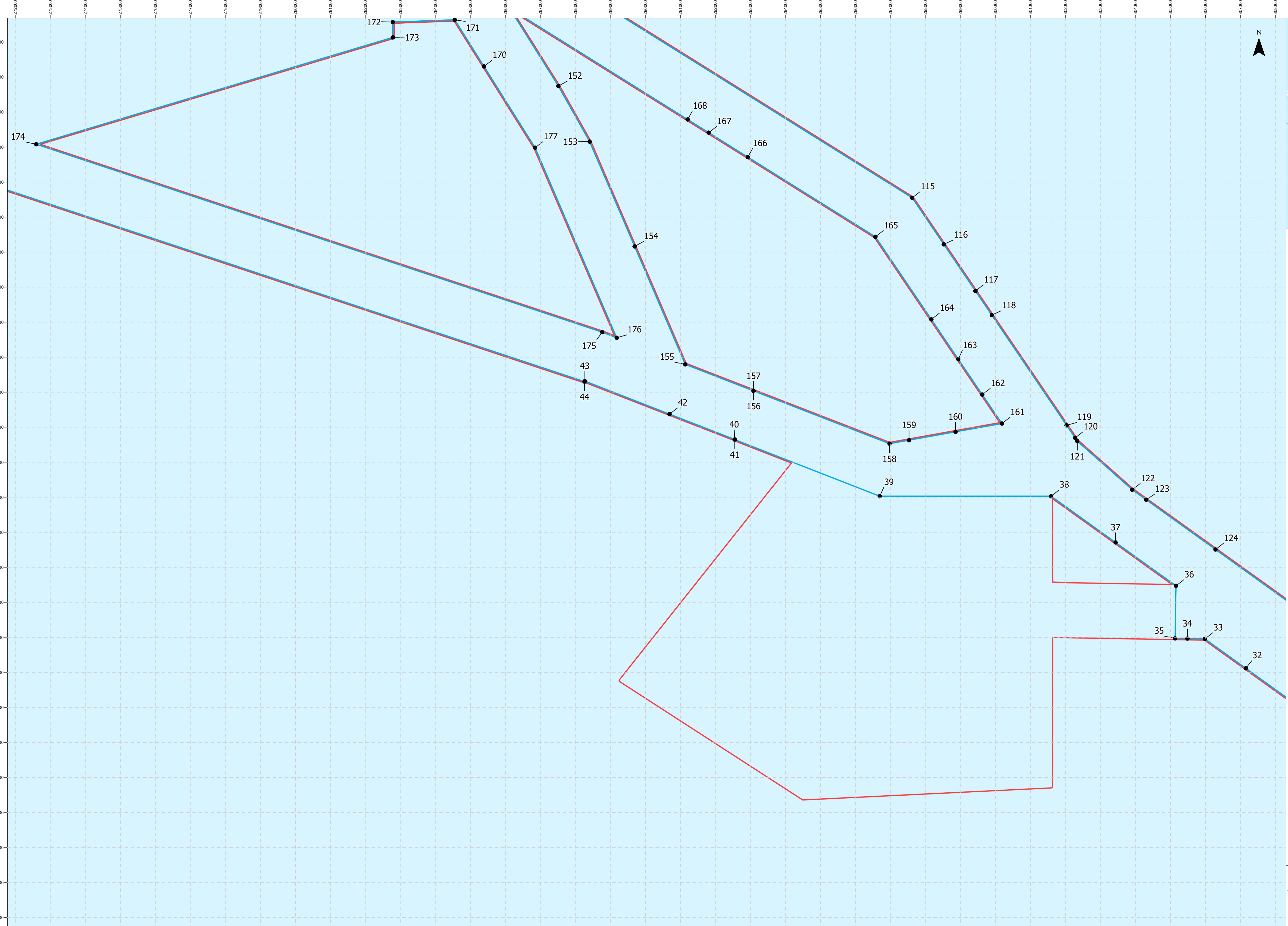

- Order Limits
- Morgan OWL: Transmission Assets Marine Licence Area
- Morgan OWL: Transmission Assets Marine Licence Area Vertices

Due to the complexity of the shape of the Marine Licence Areas, only key coordinates are shown in the plan and listed in tables. Do not recreate vector data from the coordinates given in tables.

Original GIS data is available by request.



**Project Name:**  
MORGAN AND MORECAMBE OFFSHORE WIND FARMS:  
TRANSMISSION ASSETS

**Drawing Title:**  
Indicative Extent of Marine Licences -Sheet 2 of 9  
AFPF Reg: 5(2)(o)  
Document Reference: B4

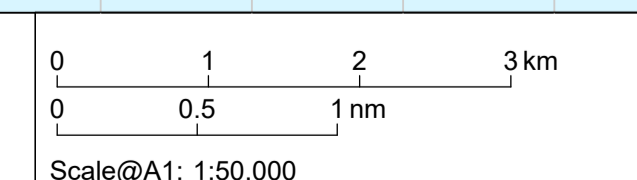

**Geodetic Information:**  
Datum: OSGB 1936  
Projection: British National Grid

**Data Sources:** BP, Ordnance Survey  
Based Upon The Ordnance Survey Map With The Sanction Of The Controller Of HM Stationery Office. Crown Copyright Reserved. © OS Licence No. 100042124

**Service Layer Credits:** GB Cartographic Local Names: Contains OS data © Crown Copyright and database right 2022  
Contains data from OS Zoomstack

VER	DATE	DETAILS	AUTH	CHK	APPRV
01	20/09/24	Final at DCO Submission	HAH	LM	AS

**Drawing Number:**  
BP-GBR-MORG-REG-0182



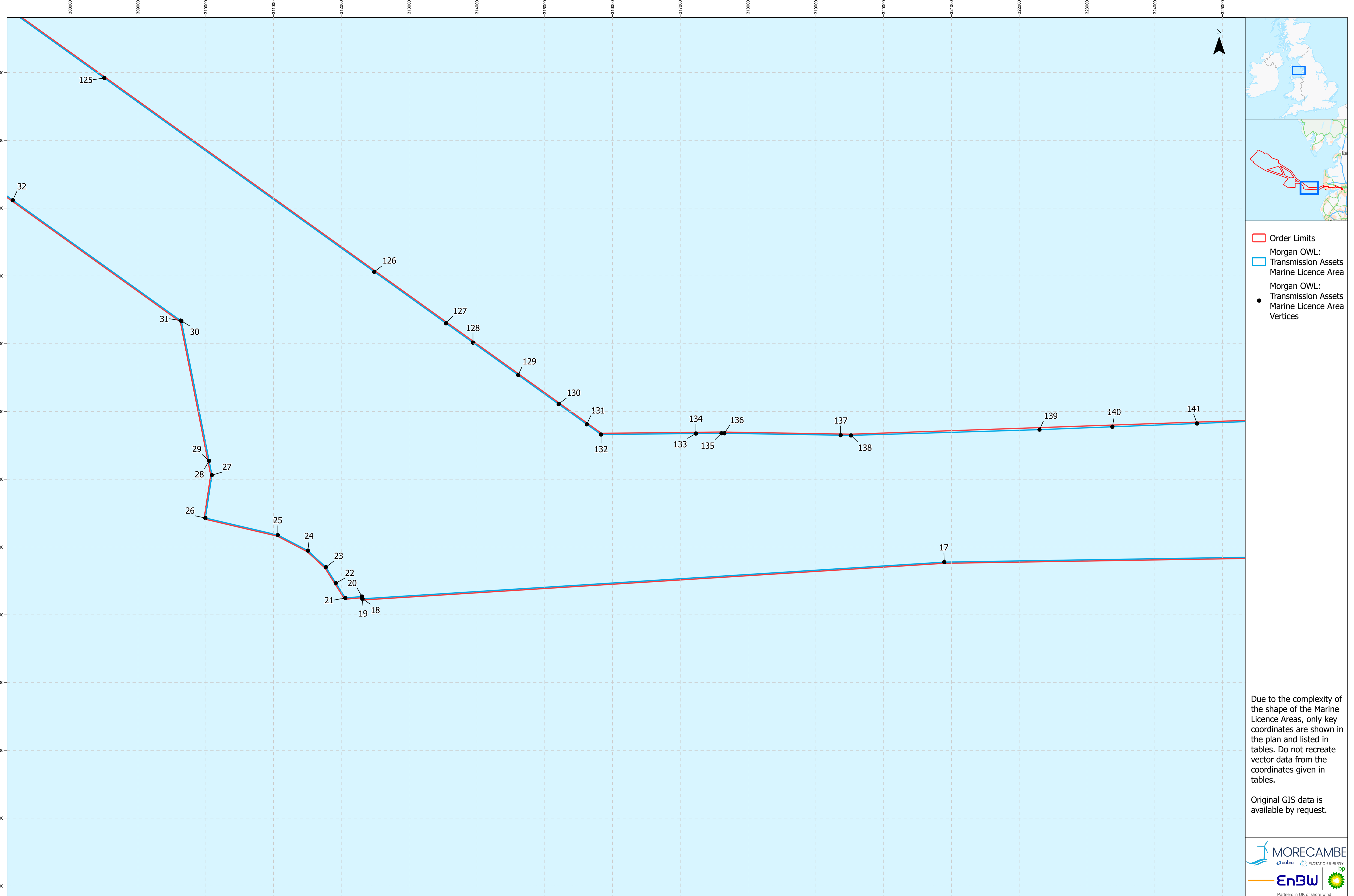

- Order Limits
- Morgan OWL: Transmission Assets
- Marine Licence Area
- Morgan OWL: Transmission Assets
- Marine Licence Area Vertices

Due to the complexity of the shape of the Marine Licence Areas, only key coordinates are shown in the plan and listed in tables. Do not recreate vector data from the coordinates given in tables.

Original GIS data is available by request.



**Project Name:**  
MORGAN AND MORECAMBE OFFSHORE WIND FARMS:  
TRANSMISSION ASSETS

**Drawing Title:**  
Indicative Extent of Marine Licences -Sheet 3 of 9  
AFPF Reg: 5(2)(o)  
Document Reference: B4

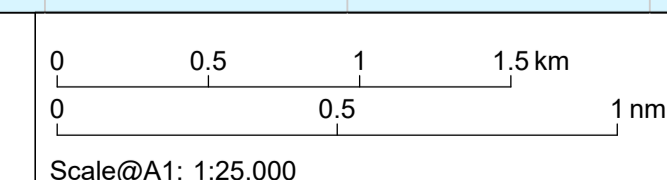

**Geodetic Information:**  
Datum: OSGB 1936  
Projection: British National Grid

**Data Sources:**BP, Ordnance Survey  
Based Upon The Ordnance Survey Map With The Sanction Of The Controller Of HM Stationery Office. Crown Copyright Reserved. © OS Licence No. 100042124

**Service Layer Credits:** GB Cartographic Local Names: Contains OS data © Crown Copyright and database right 2022  
Contains data from OS Zoomstack

VER	DATE	DETAILS	AUTH	CHK	APPRV
01	20/09/24	Final at DCO Submission	HAH	LM	AS

**Drawing Number:**  
BP-GBR-MORG-REG-0182



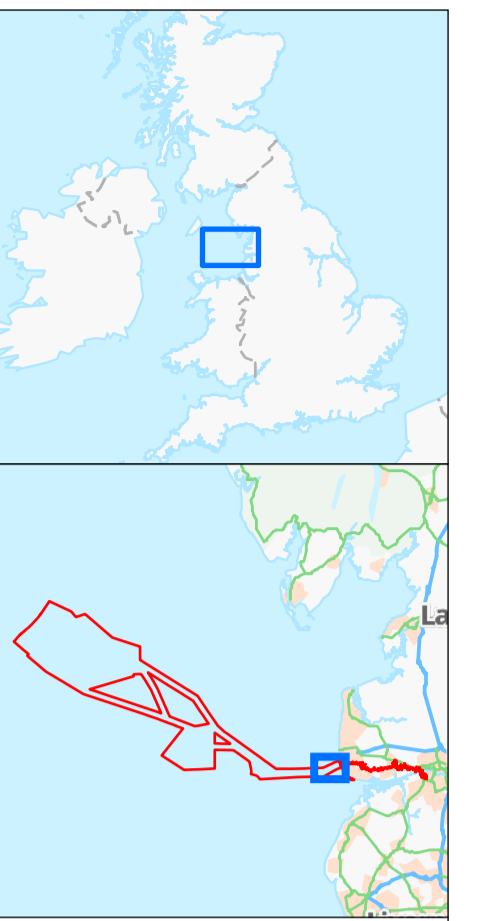
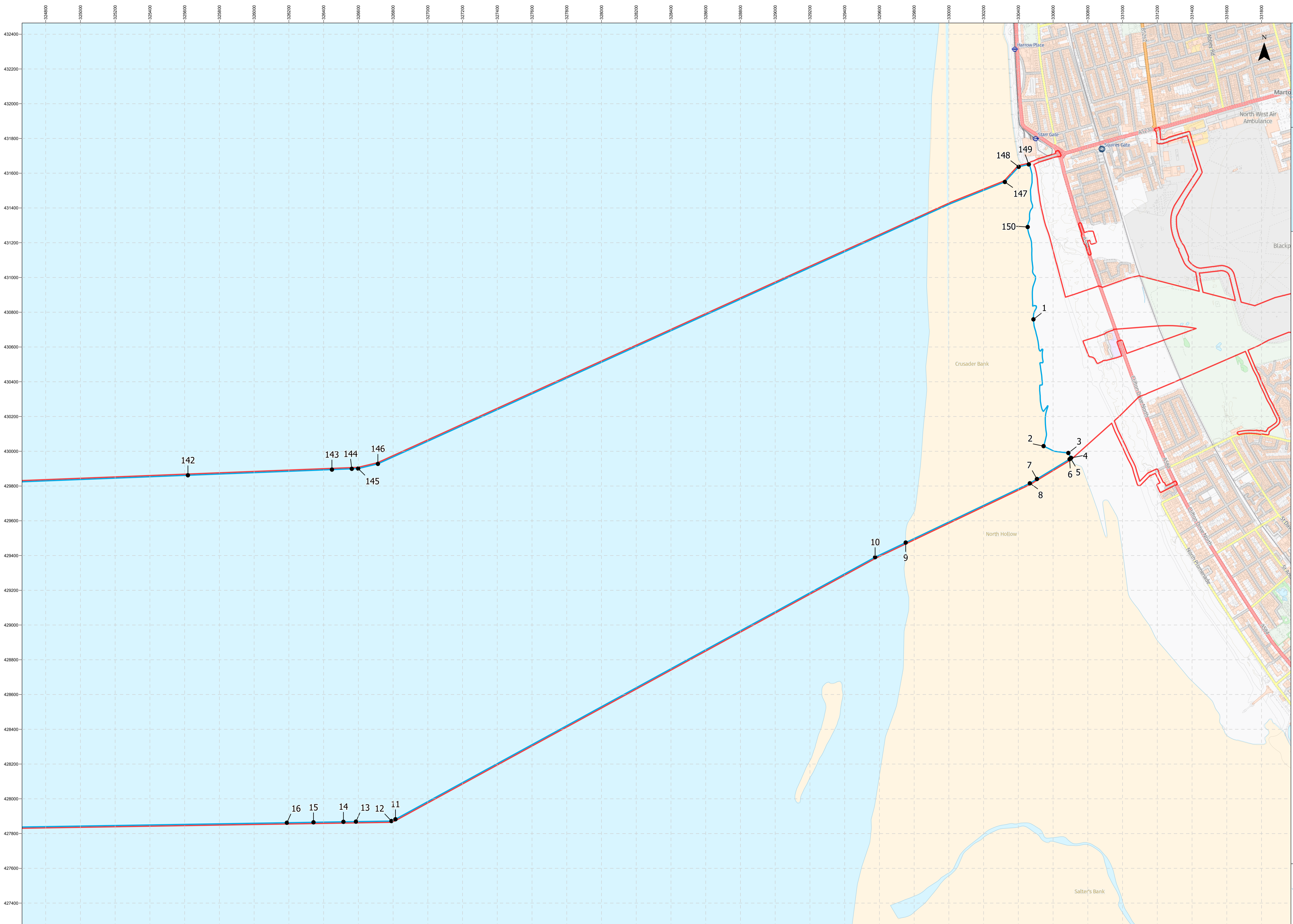

- Order Limits
- Morgan OWL: Transmission Assets
- Marine Licence Area
- Morgan OWL: Marine Licence Area
- Transmission Assets
- Marine Licence Area Vertices

Due to the complexity of the shape of the Marine Licence Areas, only key coordinates are shown in the plan and listed in tables. Do not recreate vector data from the coordinates given in tables.

Original GIS data is available by request.



**Project Name:**  
MORGAN AND MORECAMBE OFFSHORE WIND FARMS:  
TRANSMISSION ASSETS

**Drawing Title:**  
Indicative Extent of Marine Licences -Sheet 4 of 9  
AFPF Reg: 5(2)(o)  
Document Reference: B4

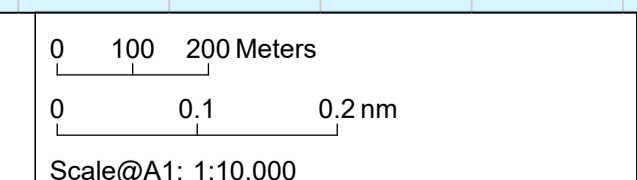

**Geodetic Information:**  
Datum: OSGB 1936  
Projection: British National Grid

**Data Sources:**BP, Ordnance Survey  
Based Upon The Ordnance Survey Map With The Sanction Of The Controller Of HM Stationary Office. Crown Copyright Reserved. © OS Licence No. 100042124

**Service Layer Credits:** GB Cartographic Local Names: Contains OS data © Crown Copyright and database right 2022  
Contains data from OS Zoomstack

VER	DATE	DETAILS	AUTH	CHK	APPRV
00	20/09/24	Final at DCO Submission	HAH	LM	AS

**Drawing Number:**  
BP-GBR-MORG-REG-0182



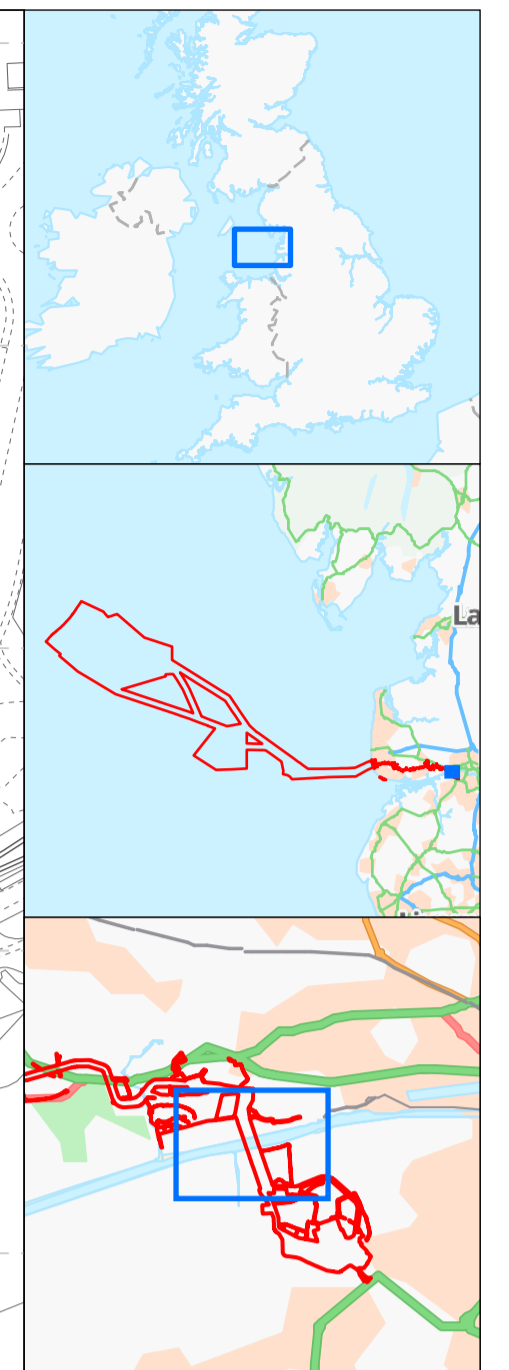
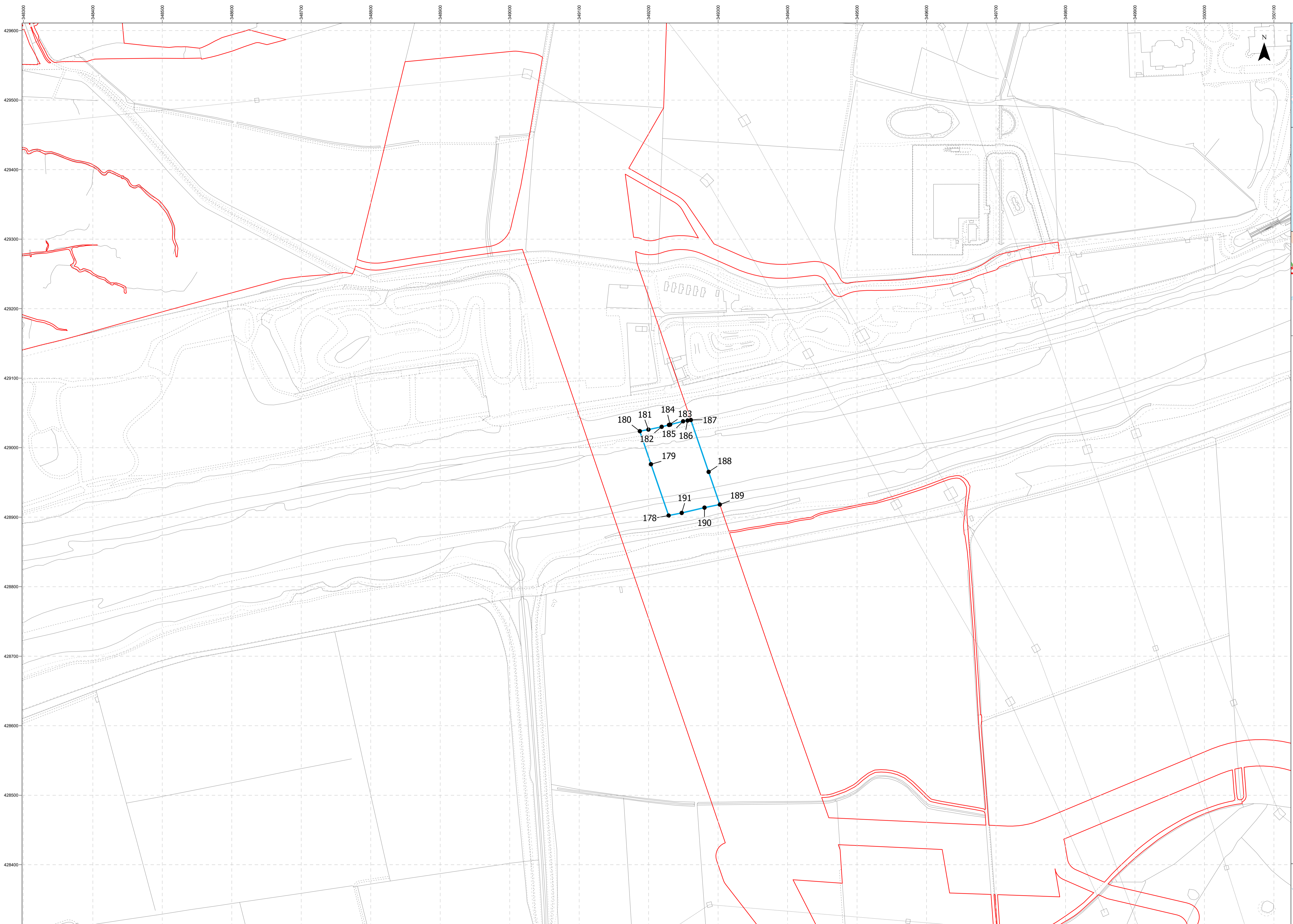

- Order Limits
- Morgan OWL:
- Transmission Assets
- Marine Licence Area
- Morgan OWL:
- Transmission Assets
- Marine Licence Area
- Vertices

Due to the complexity of the shape of the Marine Licence Areas, only key coordinates are shown in the plan and listed in tables. Do not recreate vector data from the coordinates given in tables.

Original GIS data is available by request.



**Project Name:**  
MORGAN AND MORECAMBE OFFSHORE WIND FARMS:  
TRANSMISSION ASSETS

**Drawing Title:**  
Indicative Extent of Marine Licences -Sheet 5 of 9  
AFPF Reg: 5(2)(o)  
Document Reference: B4

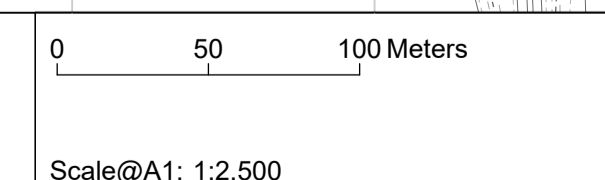

**Geodetic Information:**  
Datum: OSGB 1936  
Projection: British National Grid

**Data Sources:**BP, Ordnance Survey  
Based Upon The Ordnance Survey Map With The Sanction Of The Controller Of HM Stationery Office. Crown Copyright Reserved. © OS Licence No. 100042124

**Service Layer Credits:** GB Cartographic Local Names: Contains OS data © Crown Copyright and database right 2022. Contains data from OS Zoomstack

VER	DATE	DETAILS	AUTH	CHK	APPRV
01	20/09/24	Final at DCO Submission	HAH	LM	AS

**Drawing Number:**  
BP-GBR-MORG-REG-0182



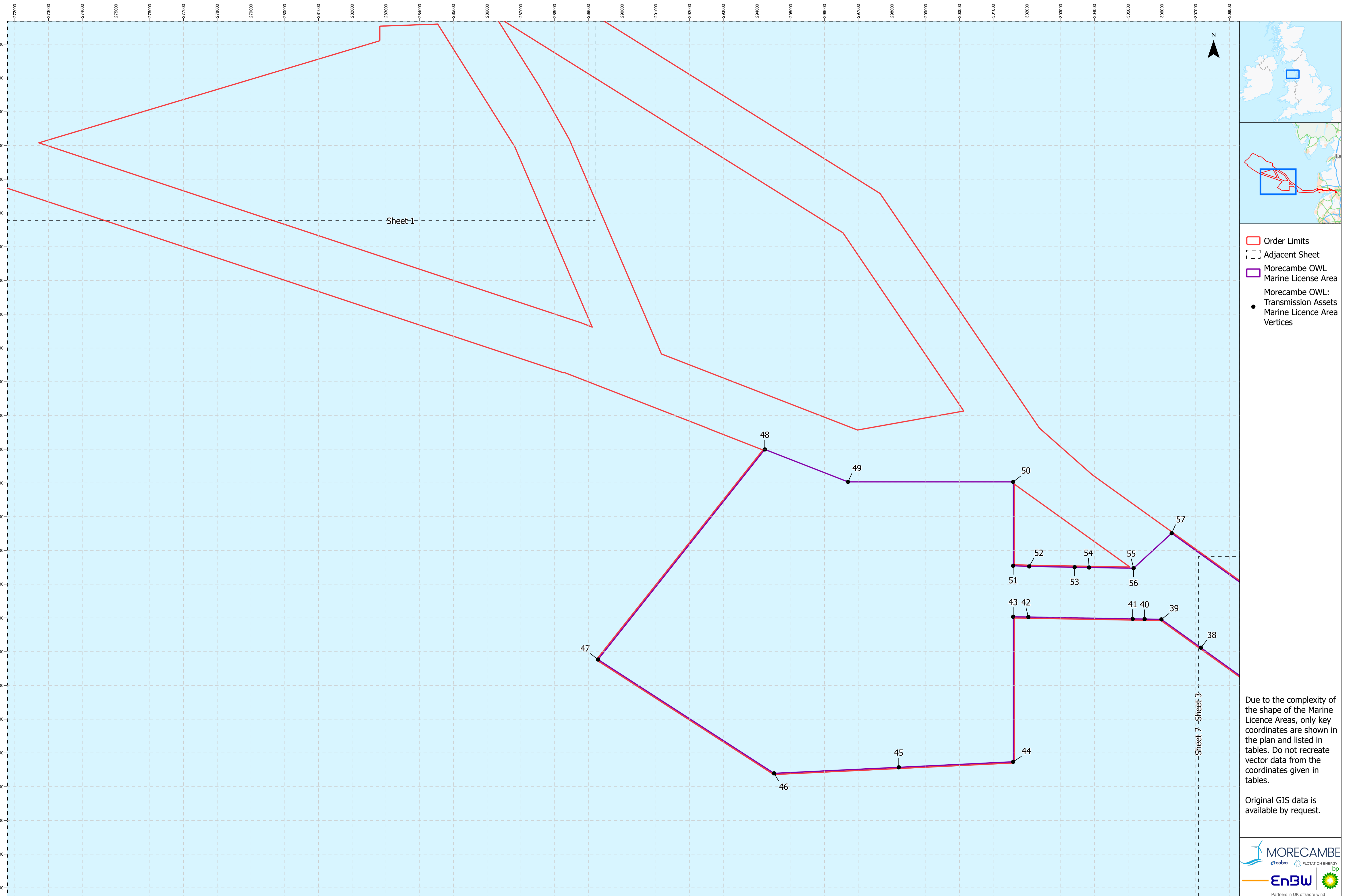

**Project Name:**  
MORGAN AND MORECAMBE OFFSHORE WIND FARMS:  
TRANSMISSION ASSETS

**Drawing Title:**  
Indicative Extent of Marine Licences - Sheet 6 of 9  
AFP Reg: 5(2)(c)  
Document Reference: B4

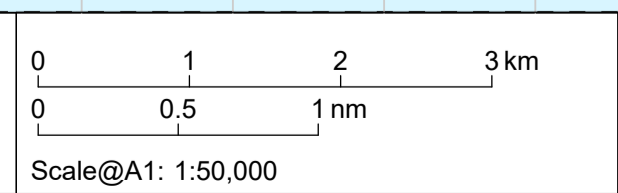

**Geodetic Information:**  
Datum: OSGB 1936  
Projection: British National Grid

**Data Sources:** BP, Ordnance Survey  
Based Upon The Ordnance Survey Map With The Sanction Of The  
Controller Of HM Stationery Office. Crown Copyright Reserved. © OS  
Licence No. 100042124

**Service Layer Credits:** GB Cartographic Local Names:  
Contains OS data © Crown Copyright and database right  
2022  
Contains data from OS Zoomstack

VER	DATE	DETAILS	AUTH	CHK	APPRV
01	20/09/24	Final at DCO Submission	HAH	LM	AS

**Drawing Number:**  
BP-GBR-MORG-REG-0182



Due to the complexity of the shape of the Marine Licence Areas, only key coordinates are shown in the plan and listed in tables. Do not recreate vector data from the coordinates given in tables.

Original GIS data is available by request.

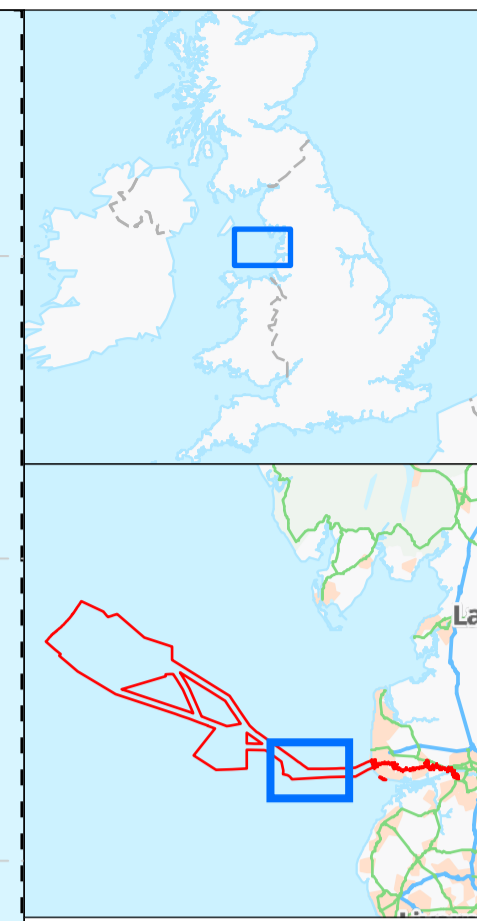
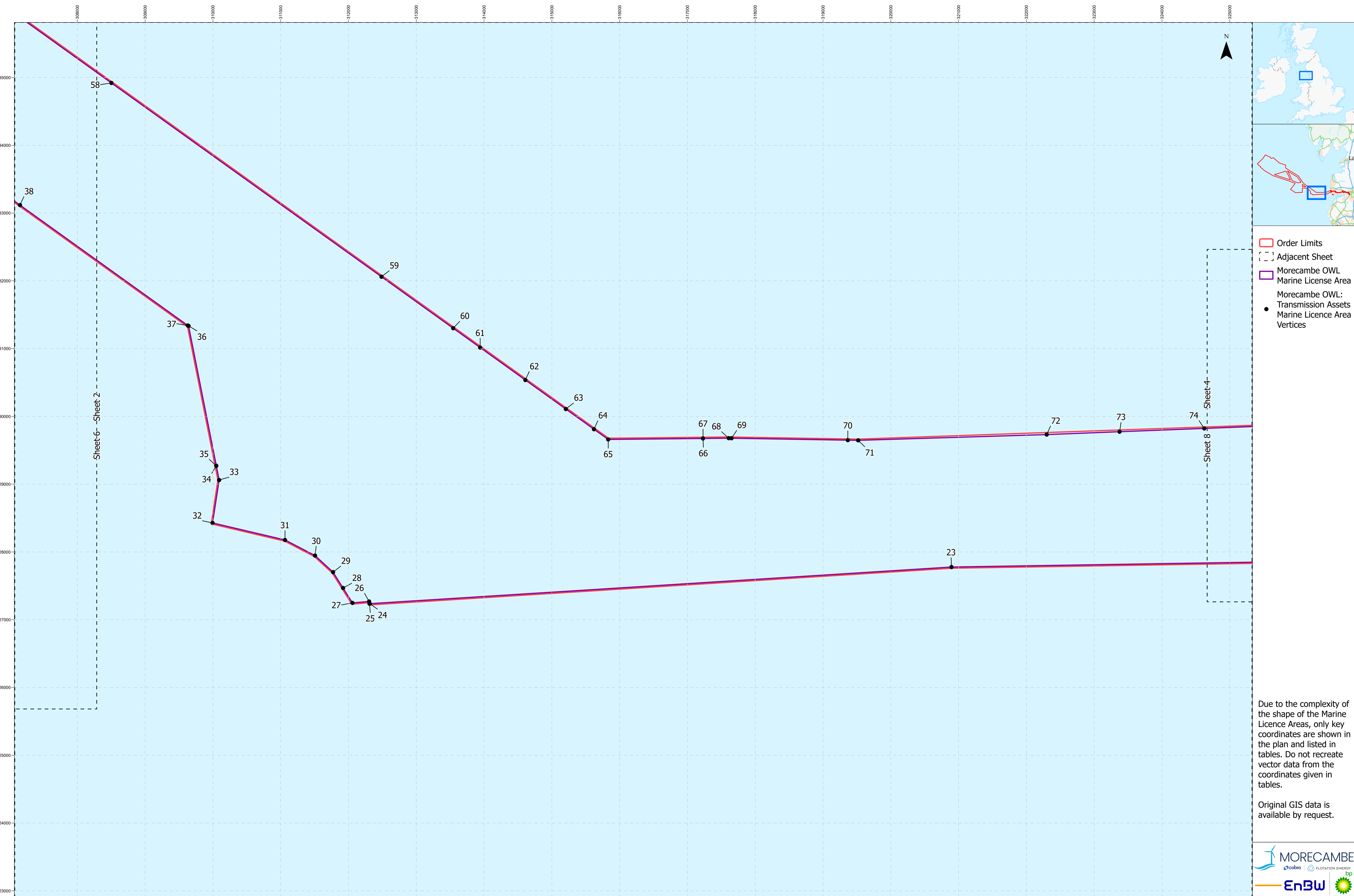

- Order Limits
- Adjacent Sheet
- Morecambe OWL
- Marine Licence Area
- Morecambe OWL:
  - Transmission Assets
  - Marine Licence Area Vertices

Due to the complexity of the shape of the Marine Licence Areas, only key coordinates are shown in the plan and listed in tables. Do not recreate vector data from the coordinates given in tables.

Original GIS data is available by request.



**Project Name:**  
MORGAN AND MORECAMBE OFFSHORE WIND FARMS:  
TRANSMISSION ASSETS

**Drawing Title:**  
Indicative Extent of Marine Licences - Sheet 7 of 9  
AFPP Reg: 5(2)(c)  
Document Reference: B4

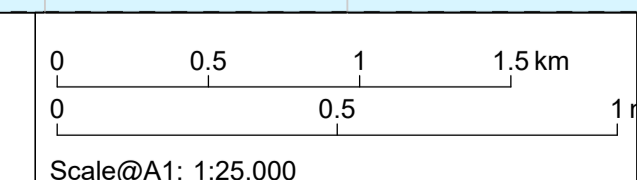

**Geodetic Information:**  
Datum: OSGB 1936  
Projection: British National Grid

**Data Sources:** BP, Ordnance Survey  
Based Upon The Ordnance Survey Map With The Sanction Of The Controller Of HM Stationary Office. Crown Copyright Reserved. © OS Licence No. 100042124

**Service Layer Credits:** GB Cartographic Local Names: Contains OS data © Crown Copyright and database right 2022  
Contains data from OS Zoomstack

VER	DATE	DETAILS	AUTH	CHK	APPRV
01	20/09/24	Final at DCO Submission	HAH	LM	AS

**Drawing Number:**  
BP-GBR-MORG-REG-0182



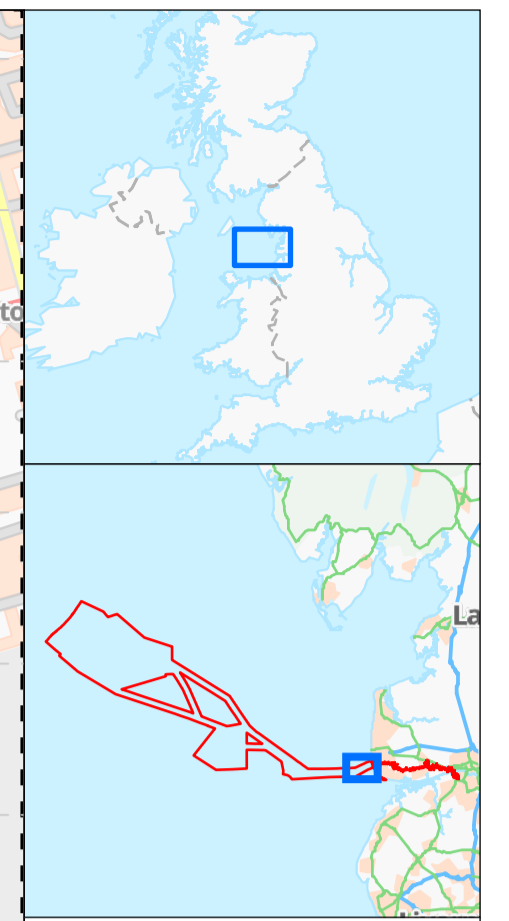
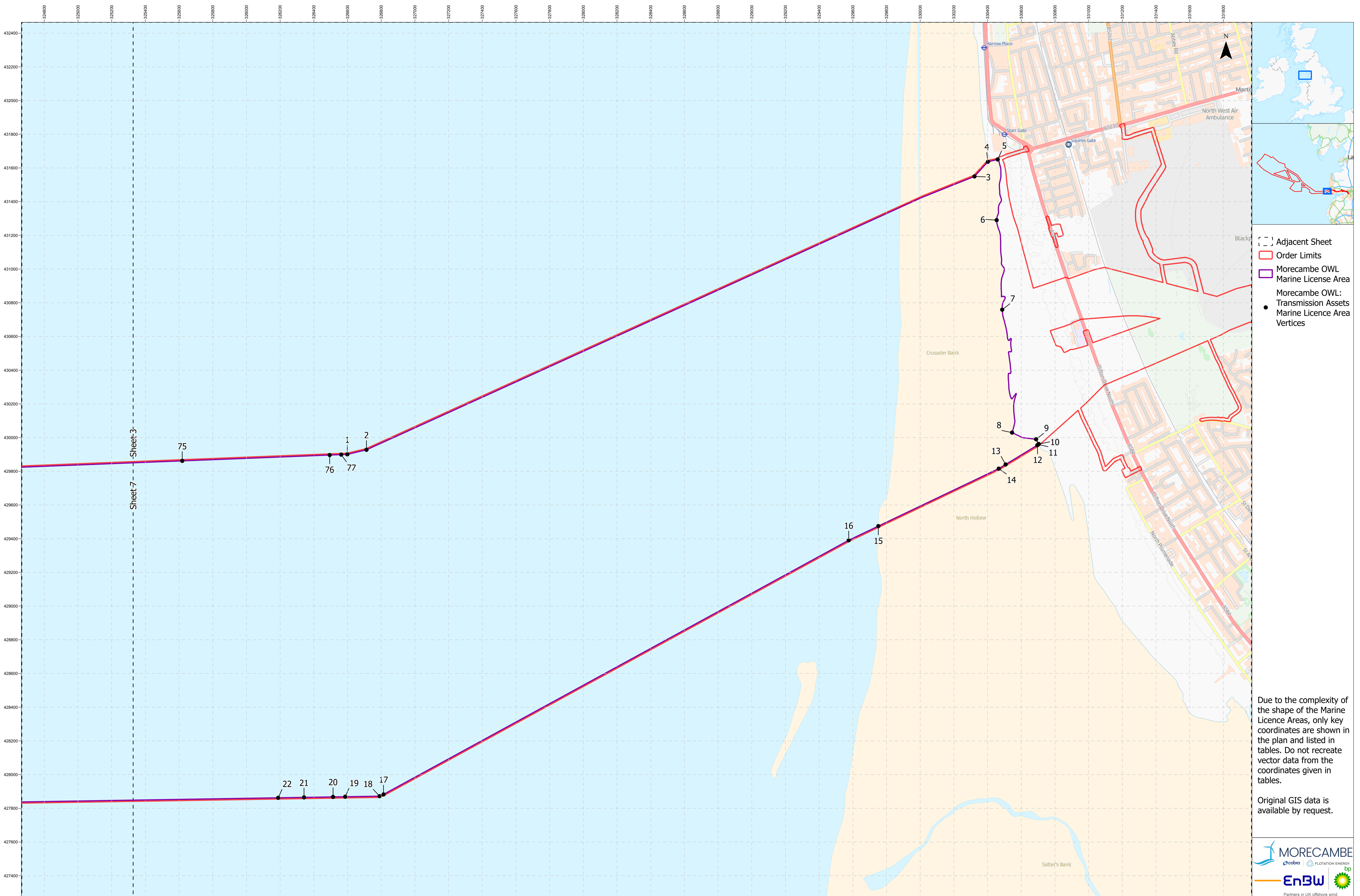

- [-] Adjacent Sheet
- [Red Line] Order Limits
- [Purple Line] Morecambe OWL
- [Purple Line] Marine License Area
- [Black Dot] Morecambe OWL: Transmission Assets
- [Black Dot] Marine Licence Area Vertices

Due to the complexity of the shape of the Marine Licence Areas, only key coordinates are shown in the plan and listed in tables. Do not recreate vector data from the coordinates given in tables.

Original GIS data is available by request.



**Project Name:**  
MORGAN AND MORECAMBE OFFSHORE WIND FARMS:  
TRANSMISSION ASSETS

**Drawing Title:**  
Indicative Extent of Marine Licences - Sheet 8 of 9  
AFPP Reg: 5(2)(e)  
Document Reference: B4

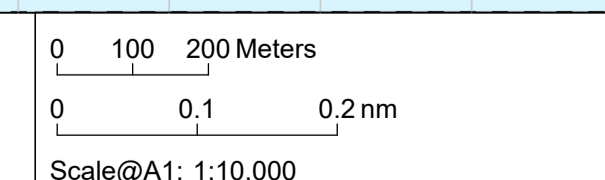

**Geodetic Information:**  
Datum: OSGB 1936  
Projection: British National Grid

**Data Sources:** BP, Ordnance Survey  
Based Upon The Ordnance Survey Map With The Sanction Of The Controller Of HM Stationery Office. Crown Copyright Reserved. © OS Licence No. 100042124

**Service Layer Credits:** GB Cartographic Local Names: Contains OS data © Crown Copyright and database right 2022  
Contains data from OS Zoomstack

VER	DATE	DETAILS	AUTH	CHK	APPRV
01	20/09/24	Final at DCO Submission	HAH	LM	AS

**Drawing Number:**  
BP-GBR-MORG-REG-0182



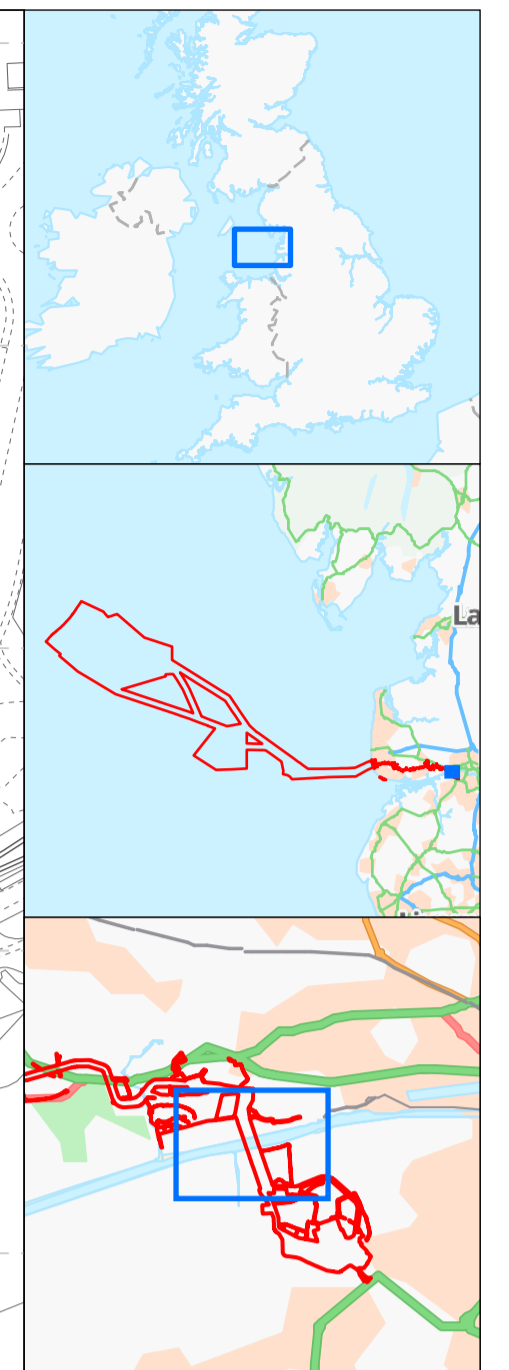
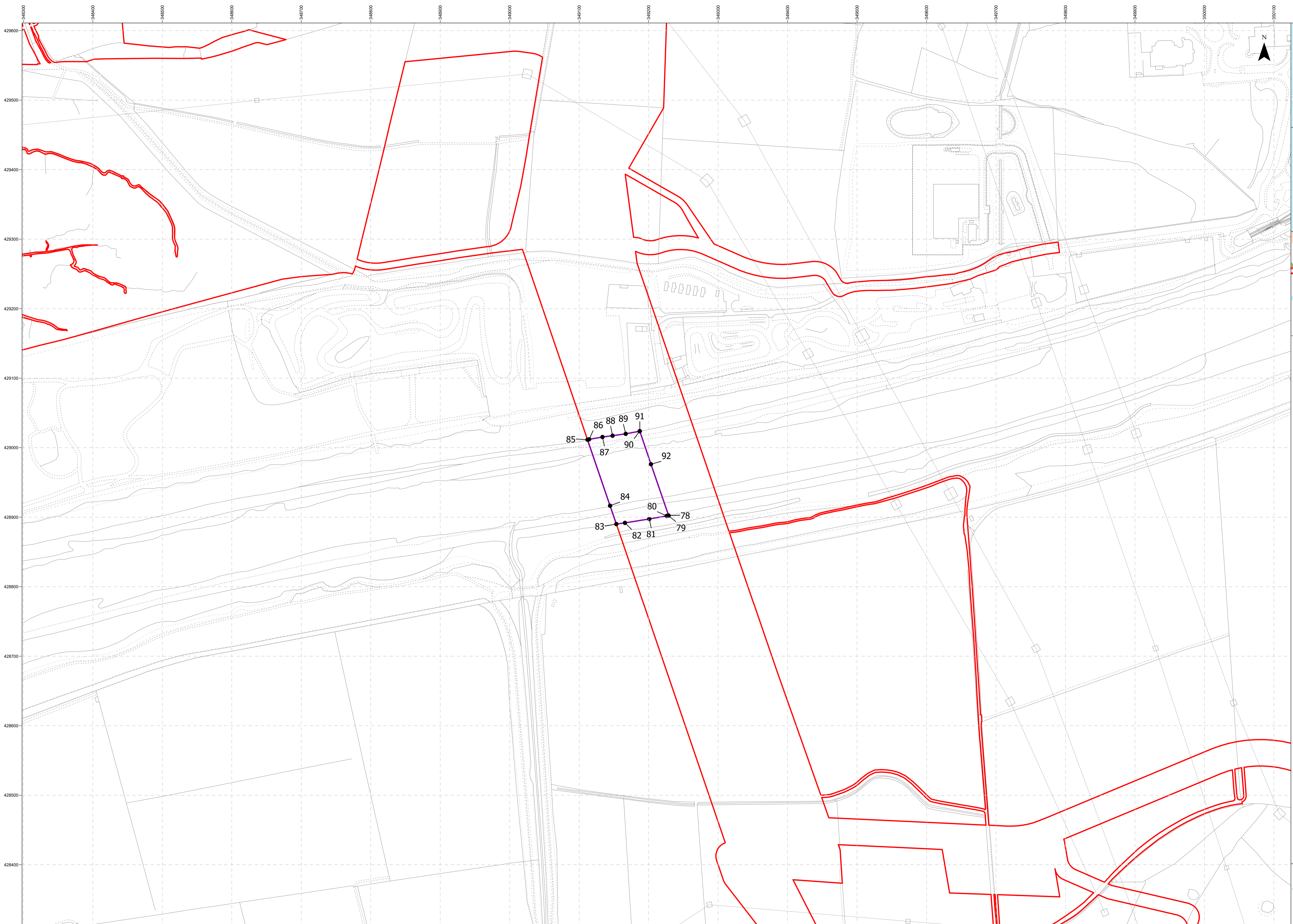

- ▭ Order Limits
- ▭ Morecambe OWL
- ▭ Marine Licence Area
- Morecambe OWL:
  - Transmission Assets
  - Marine Licence Area Vertices



**Project Name:**  
MORGAN AND MORECAMBE OFFSHORE WIND FARMS:  
TRANSMISSION ASSETS

**Drawing Title:**  
Indicative Extent of Marine Licences - Sheet 9 of 9  
AFPP Reg: 5(2)(e)  
Document Reference: B4

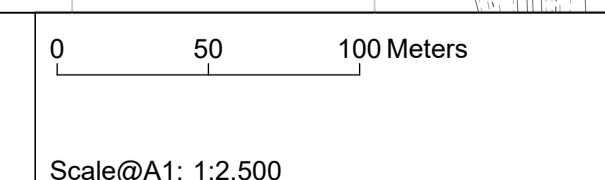

**Geodetic Information:**  
Datum: OSGB 1936  
Projection: British National Grid

**Data Sources:**BP, Ordnance Survey  
Based Upon The Ordnance Survey Map With The Sanction Of The  
Controller Of HM Stationery Office. Crown Copyright Reserved. © OS  
Licence No. 100042124

**Service Layer Credits:** GB Cartographic Local Names:  
Contains OS data © Crown Copyright and database right  
2022  
Contains data from OS Zoomstack

VER	DATE	DETAILS	AUTH	CHK	APPRV
01	20/09/24	Final at DCO Submission	HAH	LM	AS

**Drawing Number:**  
BP-GBR-MORG-REG-0182





Table 2A: Morecambe OWL Marine Licence Area Vertices - Offshore ECC

Label	Easting	Northing	Long_OSGB36_DD	Lat_OSGB36_DD
1	326598.88	429900.39	-3.113517	53.760063
2	326712.64	429927.46	-3.111798	53.760322
3	330322.21	431549.81	-3.057416	53.775399
4	330401.95	431636.78	-3.056226	53.776191
5	330460.12	431650.69	-3.055346	53.776324
6	330453.75	431290.55	-3.055362	53.773086
7	330486.80	430759.10	-3.05474	53.768314
8	330545.25	430029.60	-3.05369	53.761765
9	330687.80	429990.10	-3.051518	53.761429
10	330703.80	429961.90	-3.051269	53.761178
11	330700.53	429959.15	-3.051318	53.761153
12	330695.03	429954.52	-3.051401	53.761111
13	330506.96	429840.42	-3.054228	53.76006
14	330466.08	429815.62	-3.054842	53.759832
15	329751.45	429474.65	-3.065604	53.756671
16	329575.39	429390.64	-3.068255	53.755892
17	326813.69	427882.37	-3.10978	53.741956
18	326790.64	427872.03	-3.110127	53.74186
19	326586.11	427868.74	-3.113227	53.741802
20	326514.11	427867.57	-3.114319	53.741781
21	326341.77	427864.80	-3.116931	53.741732
22	326188.51	427862.33	-3.119254	53.741688
23	320894.72	427777.01	-3.199486	53.740145
24	312313.07	427236.30	-3.329421	53.733913
25	312309.69	427236.08	-3.329473	53.733911
26	312303.85	427269.05	-3.32957	53.734206
27	312058.45	427248.08	-3.333284	53.733976
28	311919.77	427468.11	-3.335449	53.73593
29	311772.15	427702.31	-3.337753	53.73801
30	311506.45	427946.51	-3.34185	53.740159
31	311063.18	428176.79	-3.348636	53.742153
32	309994.99	428427.99	-3.364902	53.744227
33	310091.37	429061.48	-3.363625	53.749937
34	310049.84	429271.01	-3.364316	53.751813
35	310049.79	429271.24	-3.364317	53.751815
36	309640.81	431334.72	-3.371122	53.770287
37	309629.32	431341.26	-3.371298	53.770344
38	307154.26	433117.77	-3.409378	53.785873
39	305984.87	433957.11	-3.427379	53.793206
40	305486.73	433965.82	-3.434942	53.793194
41	305133.42	433972.00	-3.440306	53.793185
42	302040.62	434026.06	-3.487262	53.793098
43	301590.89	434033.93	-3.49409	53.793084
44	301590.86	429735.72	-3.492719	53.75446
45	298199.70	429572.34	-3.544084	53.75234
46	294504.44	429394.32	-3.600049	53.750006
47	289286.61	432766.84	-3.68036	53.779226
48	294229.79	438993.00	-3.607508	53.836199
49	296694.90	438031.57	-3.569735	53.828056
50	301590.92	438031.59	-3.495368	53.829006
51	301590.90	435546.12	-3.494573	53.806672
52	302066.86	435526.05	-3.487341	53.806582
53	303412.16	435502.54	-3.46691	53.806622
54	303842.22	435495.02	-3.460378	53.806634
55	305159.64	435471.99	-3.44037	53.806669
56	305160.11	435472.42	-3.440363	53.806673
57	306288.32	436509.46	-3.42355	53.816196
58	308503.27	434919.60	-3.389442	53.802304
59	312486.51	432060.48	-3.32816	53.777296
60	313544.54	431301.04	-3.311894	53.770648
61	313942.11	431015.67	-3.305784	53.768149
62	314609.18	430536.87	-3.295532	53.763956
63	315205.58	430108.79	-3.286369	53.760206
64	315621.19	429810.47	-3.279984	53.757593
65	315830.99	429659.88	-3.276761	53.756273
66	317229.37	429674.68	-3.255559	53.75663
67	317229.71	429674.68	-3.255554	53.75663
68	317608.40	429678.69	-3.249812	53.756726
69	317649.79	429677.96	-3.249184	53.756726
70	319365.71	429649.52	-3.223154	53.756739
71	319518.57	429646.88	-3.220835	53.756739
72	322299.25	429732.07	-3.178686	53.757927
73	323374.43	429773.86	-3.16239	53.758462
74	324623.63	429822.54	-3.143456	53.759081
75	325618.71	429861.81	-3.128374	53.759577
76	326494.05	429896.36	-3.115106	53.760012
77	326562.28	429899.05	-3.114071	53.760046

Table 2B: Morecambe OWL Marine Licence Area Vertices - Ribble Crossing

Label	Easting	Northing	Long_OSGB36_DD	Lat_OSGB36_DD
78	349228.76	428902.34	-2.770092	53.753789
79	349228.54	428902.29	-2.770096	53.753789
80	349225.99	428901.78	-2.770134	53.753784
81	349200.91	428897.44	-2.770514	53.753743
82	349165.88	428891.84	-2.771044	53.753689
83	349153.50	428890.13	-2.771232	53.753672
84	349144.49	428916.50	-2.771373	53.753908
85	349112.02	429011.44	-2.771881	53.754759
86	349114.37	429012.04	-2.771845	53.754764
87	349133.55	429015.35	-2.771555	53.754796
88	349148.10	429017.20	-2.771335	53.754814
89	349167.02	429019.91	-2.771048	53.75484
90	349187.00	429023.67	-2.770746	53.754876
91	349187.32	429023.73	-2.770741	53.754876
92	349203.32	428976.18	-2.77049	53.754451



<b>Project Name:</b> MORGAN AND MORECAMBE OFFSHORE WIND FARMS: TRANSMISSION ASSETS	<b>Drawing Title:</b> Indicative Extent of Marine Licences -Morecambe OWL Marine Licence Coordinate Tables AFPP Reg: 5(2)(o) Document Reference: B4							VER	DATE	DETAILS	AUTH	CHK	APPRV	<b>Drawing Number:</b> BP-GBR-MORG-REG-0172
								01	20/09/24	Final at DCO Submission	HAA	LM	AS	